

6 5 4 3 2 1

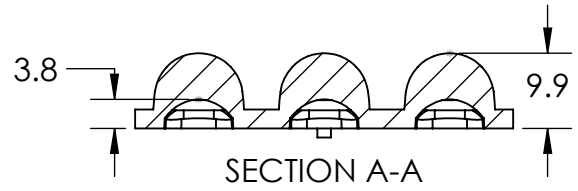
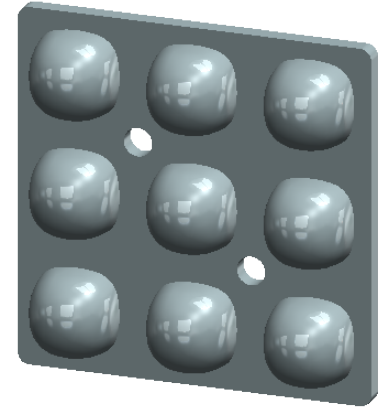
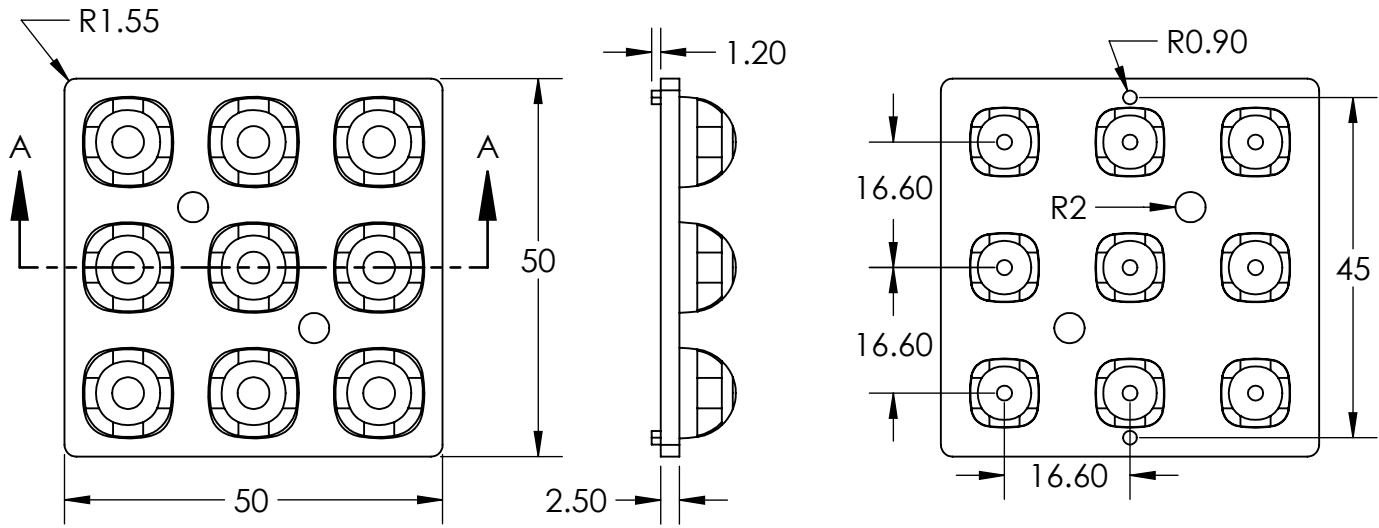

**GENERAL INFORMATION:-**

General Information

1. Lens material - Optical PC
2. Operating Temperature range  $-40^{\circ}$  ~  $+110^{\circ}$  (Upper Limit  $+130^{\circ}$ )
3. Storage Temperature range  $-40^{\circ}$  ~  $+110^{\circ}$  (Upper Limit  $+130^{\circ}$  C)

Average transmittance in visible spectrum 400nm-700nm > 90%

Usage and Maintenance:

1. If necessary, clean lenses with mild soap, water and soft cloth.
2. Never use any commercial cleaning solvents like Alcohol.
3. Handel and install lenses with wearing gloves, skin oils may Damage lenses or its optical characteristics.

**Open Tolrence  $\pm 0.2$ mm**

|   |                                    |                                    |  |   |
|---|------------------------------------|------------------------------------|--|---|
| UNLESS OTHERWISE SPECIFIED:<br>DIMENSIONS ARE IN MILLIMETERS<br>SURFACE FINISH:<br>TOLERANCES:<br>LINEAR:<br>ANGULAR: |                                    | DEBURR AND<br>BREAK SHARP<br>EDGES | DO NOT SCALE DRAWING                   | REVISION                                  |
|   |                                    |                                    | OPTIKS KARKHANA INDIA PVT. LTD.        |   |
| DRAWN   | NAME<br><b>Pradyumna Shandilya</b> | SIGNATURE                          | DATE<br>13/10/2017                     | Part Name:- <b>3x3 Highbay60°</b>         |
| CHK'D   | <b>Kapil Kaushik</b>               |                                    | 13/10/2017                             | Drawing Number:- <b>OKIPL-0059 Rev.00</b> |
| APPV'D  | <b>Kapil Kaushik</b>               |                                    | 13/10/2017                             |   |
| MATERIAL:<br><b>POLYCARBONATE</b>   |                                    |                                    | Part Number:- <b>OK59-5050-3X3-60°</b> | A4  |
| WEIGHT:   |                                    |                                    | SCALE:1:1                              | SHEET 1 OF 1                              |

D  
C  
B  
A

D  
C  
B  
A

6 5 4 3 2 1